

# A combination that truly outSMARTs the rest

## BEC22(09) range

Conlog once again makes waves in the metering world with the launch of the BEC22(09). The single-phase, prepayment electricity meter with a BS footprint is ideal for retrofit applications.

An integrated keypad and LCD ensure all customer needs are met in one compact design. In addition the meter provides a number of innovations, for example, being able to operate as a smart prepayment or post-payment meter. The device has over 50 programmable functions, to provide a high level of customisation for each utility. The meter boasts many protection features including thermal overload and line/load reversal, all designed to safeguard the meter in abnormal conditions.



### Enhanced security & protection features

Token Entry lockout  
> Protection against fraudulent token attacks

Delayed reconnection  
> In rush current protection of utility assets  
> Protects appliances from surge due to load shedding

### Features

- > Active and reactive power measurement
- > Power factor measurement
- > Renewable energy management
- > Power overload protection
- > Current overload protection
- > Thermal overload protection
- > Configurable tamper detection
- > Pre-paid and post-paid mode
- > Under and over voltage protection
- > Reverse line/load protection
- > Emergency and lifeline support
- > Configurable low credit alarm threshold



We see a world where we can all achieve more while using less



We help utilities maximise their service delivery



Our products, solutions and services are simple, efficient and innovative

# Product specifications

## Voltage ratings

Nominal voltage (-20% +15%)	220VAC - 240VAC	110VAC - 127VAC
Supply frequency ( $\pm 2\%$ )	50Hz / 60Hz	60Hz

## Current ratings

Base current ( $I_b$ )	5A
Max current ( $I_{max}$ )	100A
Min starting current	
Class 1	20mA
Class 2	25mA
Utilisation category	UC2
Minimum start up (230V)	130V
Minimum operating (230V)	120V

## Nominal power consumption

1.2W / 9VA

## Accuracy

Class 1 and 2 (maintained throughout life cycle of product)

## Over voltage rating

1.8 times the nominal voltage for 48 hours

## Short circuit rating

Short-circuit withstand 3.0kA

## Protection

Power overload	Thermal overload
Current overload	Line / load reversal
Over / under voltage	Delayed reconnection
Extreme over current	

## Environmental

Operating temperature	-10°C to +55°C
Storage temperature	-25°C to +70°C
Humidity	95% non-condensing
IP rating	IP 54
RF immunity	30V/m

## Status indicators

Rate LED (1000 pulses / kWh)

## Installation

Footprint	British standard BS footprint
Insulation class	Double insulation

## Terminals

Type	Cage clamp
Maximum size	25mm <sup>2</sup>

Live	Neutral
Cage clamp	Cage clamp
25mm <sup>2</sup>	25mm <sup>2</sup>

## Interrogation

Type	Direct probe, e-USB, flags
------	----------------------------

## Security

Meter housing	Security seals
Tamper protection	Tamper terminal cover Tamper detection

## Standards

IEC 62051-1	SANS 1524-4	SANS 1524-1-1
IEC 62052-11	SANS 15417	SANS 1524-1-2
IEC 62053-21	STS 101-1	OHSAS 18001
IEC 62055-31	STS 201-15.1.0	ISO 14001
IEC 62055-41	DSP 34-749	ISO 9001
IEC 62055-51	DSP 34-1635	SANS 1524-1
IEC 62055-52	RES/RR/00/11740	IEC 62056-21

## Packaging

Units per carton	10
Carton weight (incl. box)	6.5kg

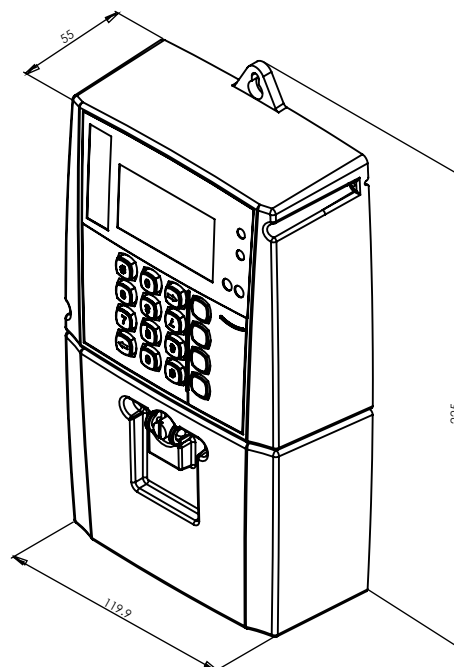
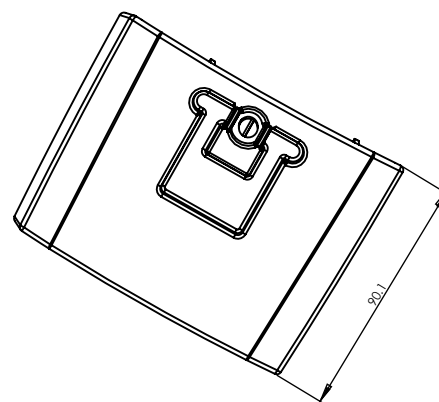
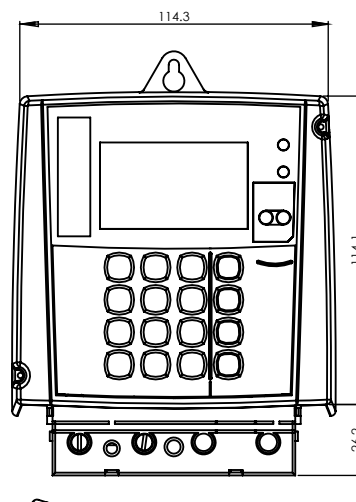

## Conlog

Conlog (Pty) Ltd  
 Reg.No. 1982/011895/07  
 P O Box 2332, Durban, 4000, South Africa  
 Tel +27 (31) 268-1111 Fax +27 (31) 268-1500  
 www.conlog.co.za  
 info@conlog.co.za